

ABUTMENT SECTION FOR STRUCTURES WITHOUT APPROACH SLABS

ISSUED: 2009

PLATE
3.3-2

ANGLE BETWEEN ϕ STRINGER AND ϕ BEARING	* A MIN.
$75^{\circ} < \theta < 90^{\circ}$	1'-0"
$45^{\circ} < \theta \leq 75^{\circ}$	1'-3"

DESIGNER TO VERIFY THAT EACH BRIDGE
* MEETS THE BEARING RESISTANCE AND SEISMIC
DESIGN REQUIREMENTS OF THE AASHTO LRFD
SPECIFICATIONS

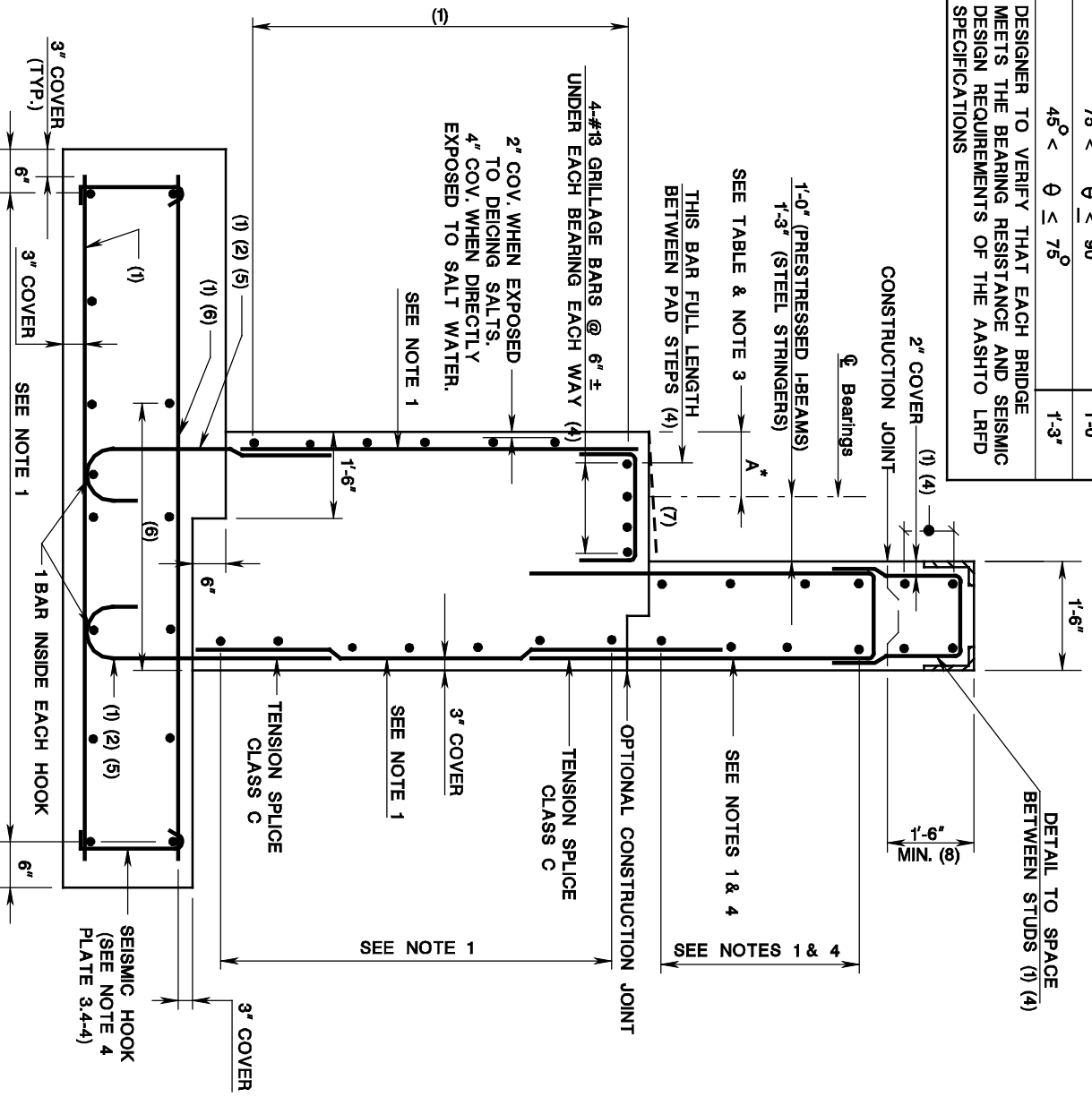

1. REINFORCEMENT NOT DESIGNATED SHALL BE AS REQUIRED BY DESIGN.
2. SEE PLATE 3.4-4 FOR ALTERNATE DOWEL DETAIL.
3. EDGE OF BRIDGE SEAT SHALL PROJECT AT LEAST 3" BEYOND THE EDGE OF THE BEARING MASONRY PLATE.
4. CORROSION PROTECTED BARS.
5. CORROSION PROTECTED DOWELS IN CORROSIVE ENVIRONMENTS.
6. TRANSVERSE STEEL IN TOP OF FOOTING SHALL BE DEVELOPED IN TENSION.
7. ABUTMENT SEATS SHALL BE SLOPED 5 % FOR DRAINAGE BETWEEN THE LEVEL BEARING SEAT AREAS. REFER TO GUIDE PLATE 3.3-4 FOR MORE INFORMATION.
8. HEADER TO BE CONSTRUCTED AFTER THE DECK SLAB IS IN PLACE.